



CRYSTAL UNIT

SX-1612

Applications

- OA / AV Machine / Bluetooth / Wireless LAN

Features

- Ultra thin / Dimensions (1.6×1.2×0.45)
- Ceramic Package
- High Reliability and High Stability

Specifications



| Model | SX-1612 | |
|---|---|-------------------------|
| Nominal frequency range | 24.000~54.000 MHz | |
| Crystal cut | Fundamental [AT-cut] | |
| Storage temperature range | -40~+90°C | |
| Operating temperature range | -20~+70°C | -30~+85°C |
| Frequency temperature characteristics (Ref. to +25°C) | $\pm 15 \times 10^{-6}$ | $\pm 20 \times 10^{-6}$ |
| Frequency tolerance (at +25°C) | $\pm 15 \times 10^{-6}$ | |
| Equivalent series resistance | 100Ω: 24.000~37.399 MHz 80Ω: 37.400~54.000 MHz | |
| Load capacitance | 8pF | |
| Shunt capacitance | 5pF max. | |
| Level of drive | 10 μW (100 μW max.) | |

Package quantity: 3,000pcs max./Reel.

Outline and Dimensions [unit:mm]

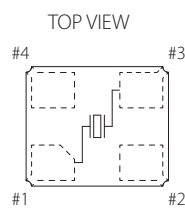
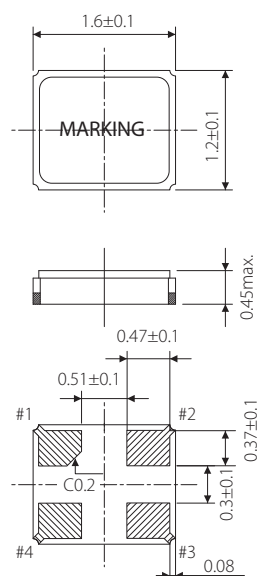

- #1, #3 : Crystal terminal
- #2 : GND(Connected to cover) #4 : GND(NC)

Example of a Terminal Land Pattern

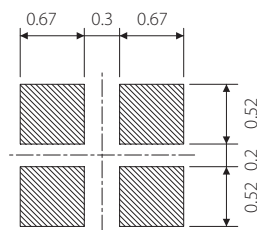

| Maximum marking length | | Marking |
|------------------------|-------|---|
| line1 | line2 | |
| 4 | 4 | Laser |
| ex.) | | <div style="border: 1px solid black; padding: 5px; display: inline-block;"> 40 . 0 S G A </div> |